

SAMPLE VEGETATION MANAGEMENT PLAN:

HAZARD ASSESSMENT

ASPECT: SOUTHWEST	4
SLOPE*: 19%	4
FUEL TYPE (0-30 FT): SPECIMEN GARDEN	1
FUEL TYPE (31-100 FT): MOSTLY GRASS	1

TOTAL HAZARD POINTS: 10
MINIMUM HORIZONTAL CLEARANCE IN FEET: 30 X 30 X 30 X 50 FEET

*NOTE: REFER TO MARINMAPS.ORG FOR CONTOUR / SLOPE, & APPROX. PROPERTY LINE INFORMATION

VEGETATION MANAGEMENT PLAN NARRATIVE

THERE ARE CURRENTLY MATURE COAST LIVE OAKS, MAPLES AND A FEW OTHER MISCELLANEOUS NATIVE SHRUB SPECIES THROUGHOUT THE PROPERTY. THE INTENT IS TO PROPERLY MAINTAIN THE MATURE LIVE OAKS, REMOVE THE EXISTING PINE, SCOTCHBROOM AND TO THIN OUT THE EXISTING SHRUBS TO PROVIDE A FIRE BREAK FROM THE HOUSE.

PROPOSED PLANTINGS THROUGHOUT THE SITE WILL INCLUDE FIRE RESISTANT (1), IRRIGATED (2) SHRUBS, PERENNIALS AND GROUNDCOVERS (SEE PLAN).

LONG TERM MAINTENANCE SCHEDULE/GOALS

ALL FLAMMABLE FUELS WILL BE REMOVED FOR A SPACE 50'-100' AROUND THE HOME. TREES SHALL BE LIMBED 8 -10 FEET FROM THE GROUND.

NEEDLES AND LEAVES AND OTHER COMBUSTIBLE DEBRIS SHALL BE REMOVED FROM ROOFS AND GUTTERS TWICE YEARLY MINIMUM.

ALL WEEDS AND GRASSES SHALL BE CUT REGULARLY.

MOWERS, SAWS AND YARD MAINTENANCE EQUIPMENT SHALL BE EQUIPPED WITH SPARK ARRESTORS. AREAS TO BE MOWED SHALL BE CHECKED FOR ROCKS OR METAL TO AVOID SPARKING OF MOWER BLADES.

VEGETATION SHALL BE TRIMMED TO WITHIN 10'-0" OF ROADWAYS AS REQUIRED FOR DEFENSIBLE AREAS. TREES SHALL BE TRIMMED SO AS TO NOT HANG LOWER THAN 13'-6" ABOVE THE ROADWAY.

DEAD AND DYING VEGETATION SHALL BE SEASONALLY REMOVED TO REDUCE VEGETATION AND LADDER FUELS.

COORDINATE WITH ADJACENT PROPERTY OWNERS TO MAINTAIN TREE CANOPIES, VEGETATION AND LADDER FUELS ON AN ANNUAL BASIS.







NOTES

NO NATIVE GRASSES WILL BE PLANTED WITHIN THE DEFENSIBLE ZONE.

ALL PLANTED AREAS INSIDE THE DEFENSIBLE ZONES SHALL BE IRRIGATED.

ALL PLANTINGS HAVE BEEN SELECTED IN COORDINATION WITH THE, "FIRESCAPE PLANT SELECTION LIST" ON THE LIST OF THE UNIVERSITY OF CALIFORNIA COOPERATIVE EXTENSION, "PYROPHYTIC VS. FIRE RESISTANT PLANT BROCHURE."

PLANT LEGEND

	EXISTING TREES TO REMAIN		PYROPHYTIC (1) VEGETATION TO BE REMOVED.
	PROPOSED TREES		PROPOSED GROUNDCOVER
	EXISTING TREES TO REMOVE		EXISTING SHRUBS / PERENNIALS TO REMAIN
			PROPOSED SHRUBS / PERENNIALS

NOTE:

(1) REFER TO TIBURON FIRE PROTECTION STANDARD 304.1.2 FOR A LIST OF PROHIBITED PLANTS.

(2) NEW CONSTRUCTION AND REHABILITATED LANDSCAPES ≥ 1,000 SQ. FT. WILL NEED TO PREPARE A LANDSCAPE PLAN PER MARIN MUNICIPAL WATER DISTRICT (<http://www.marinwater.org>).

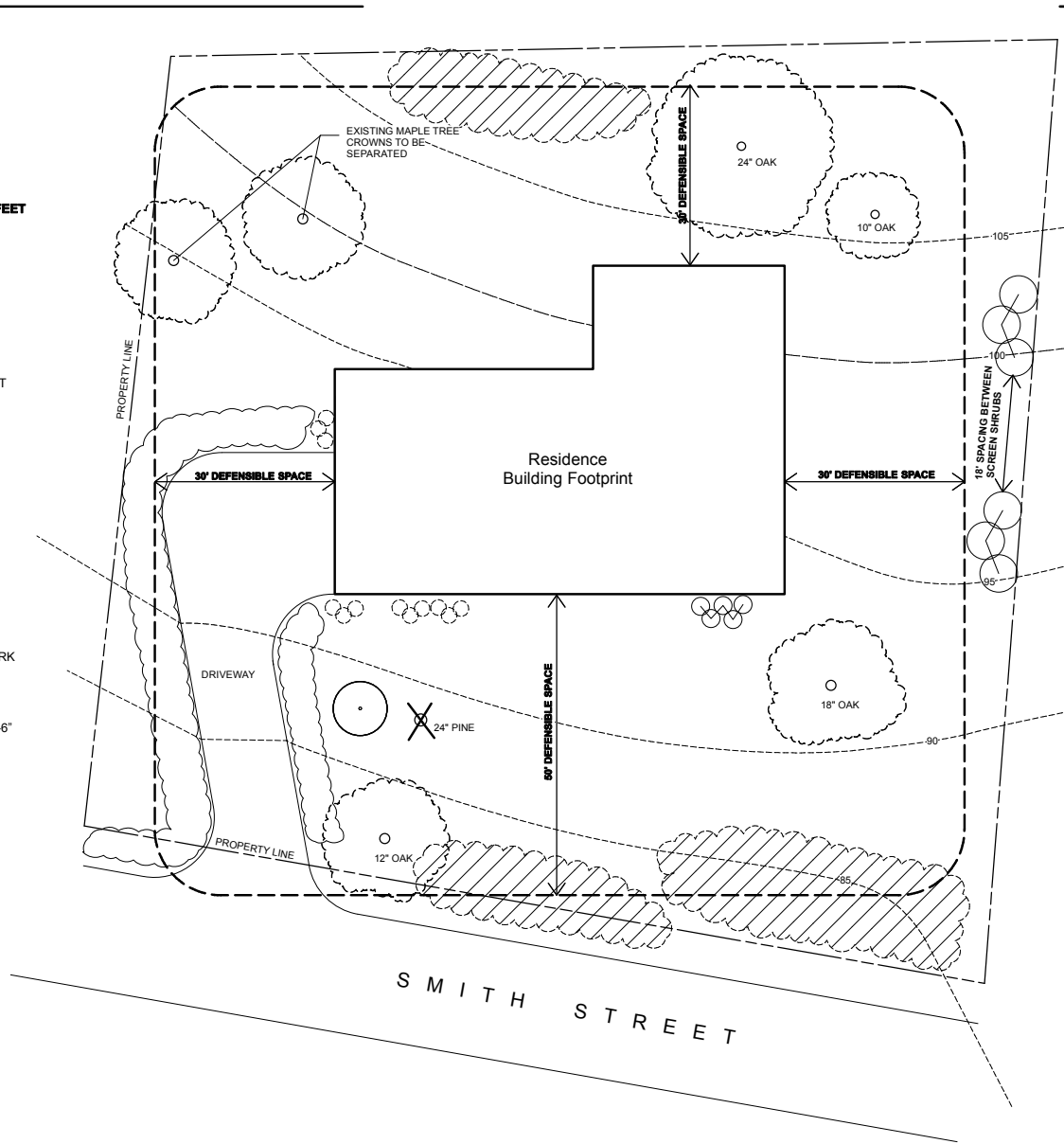

LANDSCAPE ARCHITECT'S INFORMATION

JONES RESIDENCE

APN: 000-000-00

xx/xx/13 FIRE DEPT. SUBMITTAL 1
 DATE ISSUES & REVISIONS NO.

PROJECT# 1300 DRAWN BY:
 ORIGINAL DRAWING SIZE: 24" X 36"

SCALE: 1/8" = 1' - 0"



VEGETATION MANAGEMENT PLAN

VMP